

# Installation Manual

KIA OPTIMA 4DR  
KIA-OPTI-4-A



## Shades

## Fixing Clips

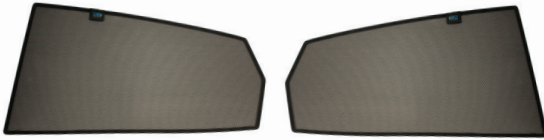

Side Shades



Port Shades

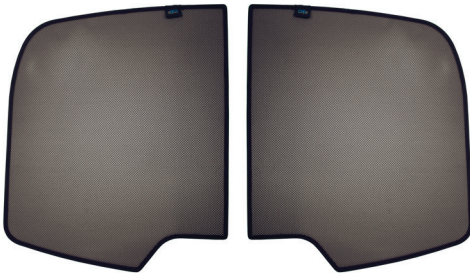

Tailgate Shades



CL-M02 x 8



CL-M12 x 2



CL-M13 x 4



CL-M14 x 2



# Installation

KIA OPTIMA 4DR  
KIA-OPTI-4-A

## Components Needed



Side Shades



CL-M13 x 4



CL-M02 x 4

## Side Shade Installation

### STEP 1

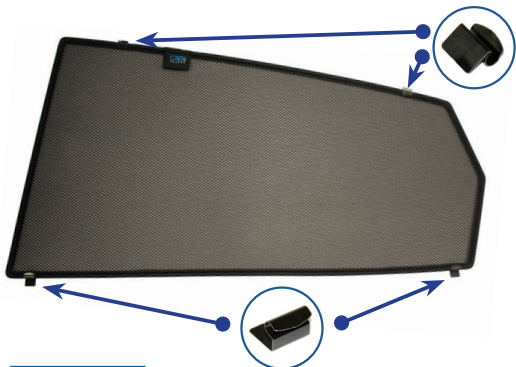

### STEP 3



### STEP 5



### STEP 2



### STEP 4



### STEP 6

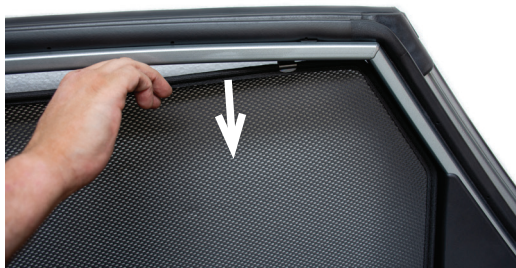

# Installation

KIA OPTIMA 4DR  
KIA-OPTI-4-A



## Side Shade Installation

### STEP 7



### STEP 8



### STEP 9



### STEP 10

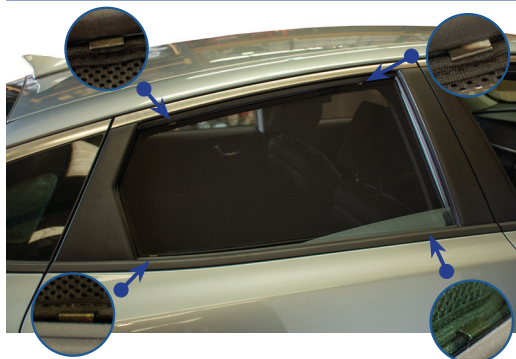

### STEP 11



Repeat this whole process for the other side



# Installation

KIA OPTIMA 4DR  
KIA-OPTI-4-A

## Components Needed



Port Shades



CL-M02 x 4

## Port Shade Installation

### STEP 1



### STEP 2



### STEP 3



### STEP 4

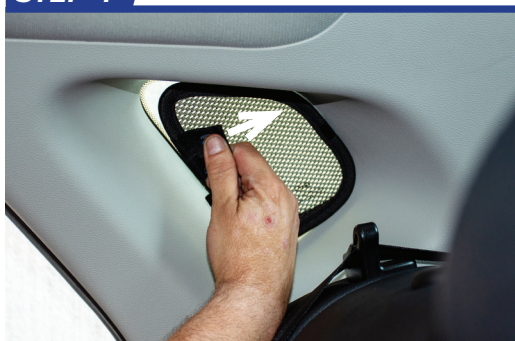

### STEP 5



### STEP 6



Repeat this whole process for the other side



# Installation

KIA OPTIMA 4DR  
KIA-OPTI-4-A

## Components Needed



Tailgate Shades



CL-M12 x 2



CL-M14 x 2

## Tailgate Shade Installation

### STEP 1

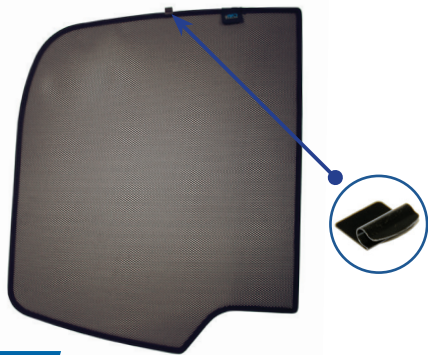

### STEP 2



### STEP 3



### STEP 4



### STEP 5



### STEP 6



Repeat this whole process for the other side

# Installation

KIA OPTIMA 4DR  
KIA-OPTI-4-A



## Tailgate Shade Installation

### STEP 7



### STEP 8



### STEP 9

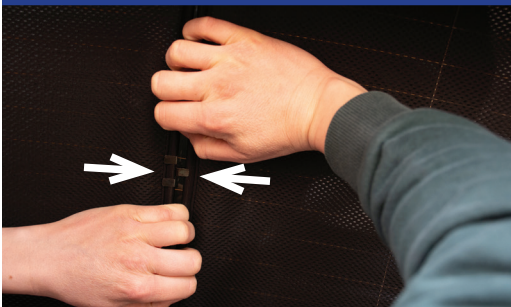

Repeat step 8 & 9 for the second CL-M14 clip

### STEP 10

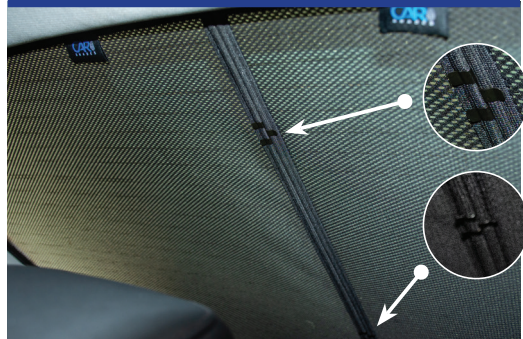

### STEP 11

